

Panasonic

for Professionals

ER-FGP74

MORE ERGONOMICS AND POWER!



Just 250 grams!

Lithium-Ion battery for greater durability and quieter use.

Power, performance, elegance and working comfort.

X-taper Blade 2.0

1 hr full charge

50 min use



MAKE ART



ER-FGP74

CONCENTRATED EXCELLENCE!

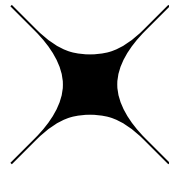

X-TAPER BLADE 2.0

UNEQUALED CUTTING PERFORMANCE!

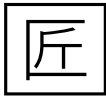

JAPANESE BLADE TECH

Japanese blades, sharpened to a 45° cutting angle for the closest cut, with a new DLC (Diamond Like Carbon) coating that conducts less heat for added comfort. A pledge of quality for you and your clientele.

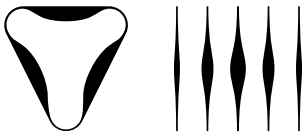

A POWERFUL LINEAR MOTOR WITH PATENTED CONSTANT CONTROL

The 10,000-rpm linear motor with constant control assures a constant powerful cut regardless of the battery charge level or hair density.

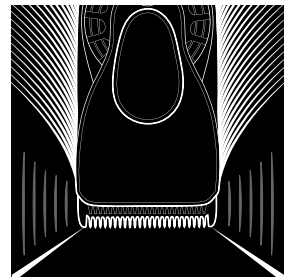

LIGHTER AND EVEN MORE ERGONOMIC!



Just 250 grams for this concentrated power. A slim silhouette offers maximum working comfort while safeguarding your health and assuring cutting pleasure. A clean design harmonizes with the esthetics of new salons.

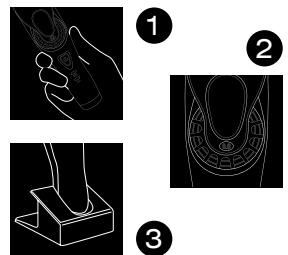

- 1 An ultra-natural grip for mixing cutting techniques
- 2 Ergonomic cutting height dial adjustment: for left- and right-handed stylists
- 3 Ultra-compact charging and storage stand optimizes your workspace

LITHIUM-ION BATTERY, QUIET USE AND DURABILITY



Recharge at any time without waiting for the battery to completely discharge. More power and durability over time.



TECHNICAL FEATURES

- Constant control linear motor
- 5 position cutting height dial adjustment: 0.8 mm to 2 mm in 0.3 mm increments
- 6 cutting lengths with 3 double combs 3/4 mm ; 6/9 mm ; 12/15 mm
- Battery charge indicator
- Works with or without a cord
- Lithium-Ion battery; automatic universal voltage
- Complete battery charge in 1 hour; Up to 50 minutes of cordless use